

384 Foster City Blvd.

Foster City | CA 94404

I | P | G



Plug&play Biology Lab and Office facility

Through December 2026 | **31,320 SF**

FOR SUBLEASE

Innovation Properties Group
181 2nd Street, San Francisco, CA
www.ipgsf.com | CL 02031924

Ivan Smiljanic | Partner
510-717-5008 | Ivan@ipgsf.com
DRE: 1995999

Rocky Kile | Director - Re & Lab Infrastructure
401-263-4218 | rocky@ipgsf.com
DRE: 02233435

ipgsf.com

384 Foster City Blvd.

I | P | G

Property Highlights

- 31,320 SF Freestanding Building
- Plug&Play Office and Lab
- Twenty-four (24) BSC Hoods
- Four (4) Chemical fume hoods
- Central Laboratory Compressed Air, Vacuum, and Purified Water Systems distributed to Labs
- Centralized Specialty Gas Systems for CO₂, Nitrogen, Oxygen and Helium located in Equipment Yard and Piped to Labs
- Single-pass HVAC for Labs
- Cold Room
- Glasswash Rooms with Steris Glass Washer, Steris Glass, Dryer and Scullery Sink
- 1,600 amps 277/480 volts
- 2 Backup Generators
 1. 150kw, 120/208v 3 phase 4 wire
 2. 150kw, 277/480v 3 phase 4 wire
- One (1) Grade Level Door
- Security System with Card Reader Building Access Control
- 3.3/1000 Parking
- Low NNN Expenses approximately \$0.30/SF

Available Now



384 Foster City Blvd.

I | P | G

Space Features

- Designed for Laboratory R&D
- Fixed/built-in laboratory furnishings remain, suitable for immediate use
- Laboratory areas in good, well-maintained condition
- Lab finishes and piped services meet life sciences industry standards
- Established Hazardous Materials (HazMat) Control Areas
- Designated H Occupancy HazMat Storage Rooms, beneficial for regulated materials handling
- Accurate and comprehensive as-built drawings and CAD files available, expediting tenant planning, equipment placement, and space customization
- Professional architectural and lab planning assessment conducted by GL Planning & Design (GLP), a specialized firm
- Remaining lab equipment includes a glass washer, glass dryer, and several fume hoods, offering a partial equipment foundation for new tenants



384 Foster City Blvd.

I | P | G

Laboratory Utility Systems

- Compressed Air System distributed to lab areas
- Vacuum System distributed to lab areas
- Purified Water System distributed to lab areas
- Two Generators for emergency and standby power electrical loads (in exterior generator enclosure)
- Centralized specialty gas systems for CO₂, Nitrogen, Oxygen and Helium located in exterior gas enclosure and piped to lab areas
- Single pass HVAC for laboratory areas

Laboratory Area Features

- All laboratory space is located on the ground floor (good for low floor vibration)
- Lab is permitted with five B Occupancy HazMat Control Areas
- Permitted H Occupancy HazMat Storage Rooms with classified electrical systems
- Working Cold Room
- Glasswash Room with Steris glass washer, Steris glass dryer and scullery sink
- Metal laboratory casework with epoxy worksurfaces in good working condition
- Security system including card reader building access control



384 Foster City Blvd.

LAB / LAB SUPPORT AREAS

I | P | G



384 Foster City Blvd.

OFFICE SPACES

I | P | G



384 Foster City Blvd.

MECHANICAL / ELECTRICAL ROOMS

I | P | G



384 Foster City Blvd.

I | P | G

Floor Plan

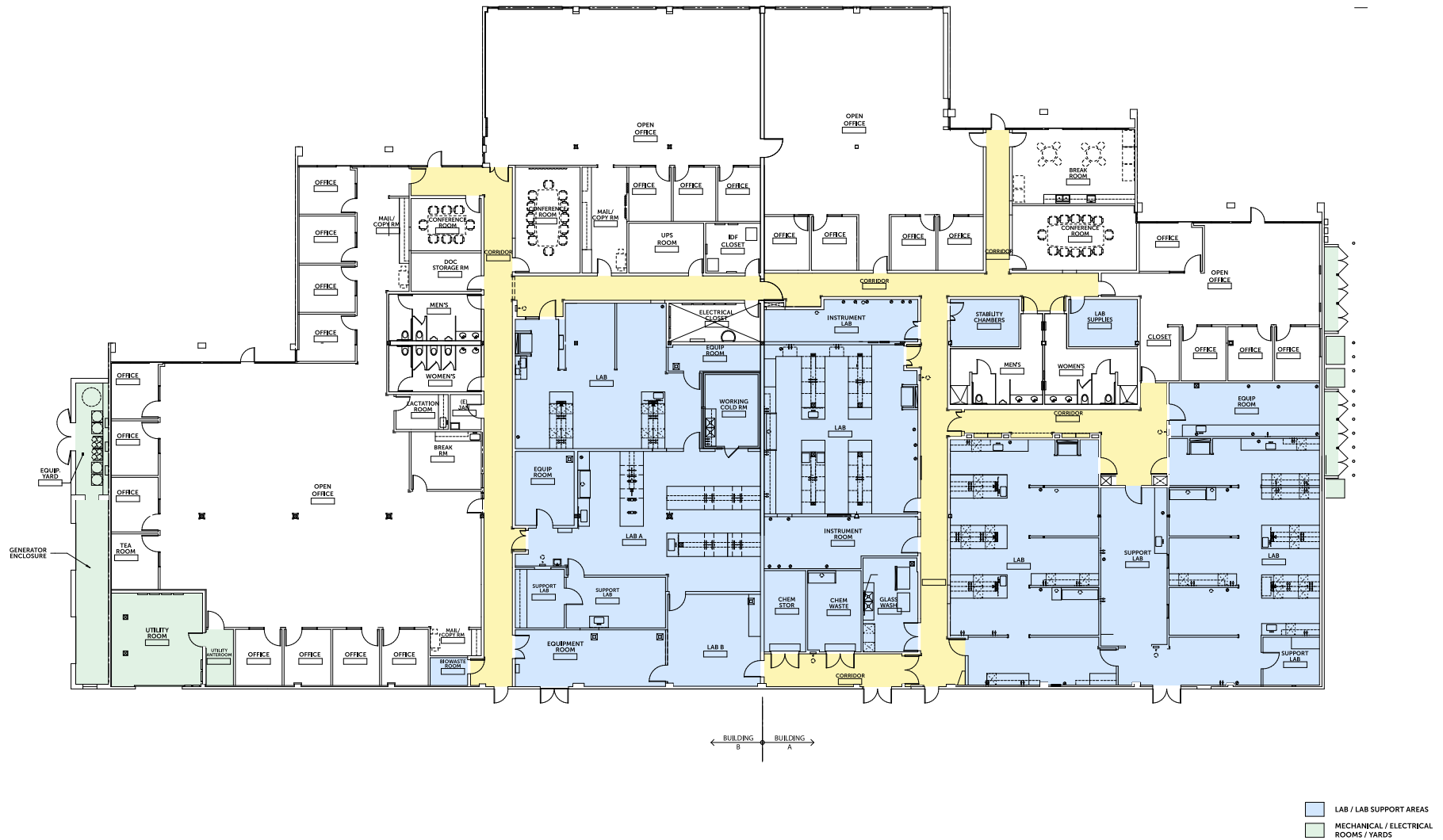

384 Foster City Blvd.

I | P | G

Site Plan

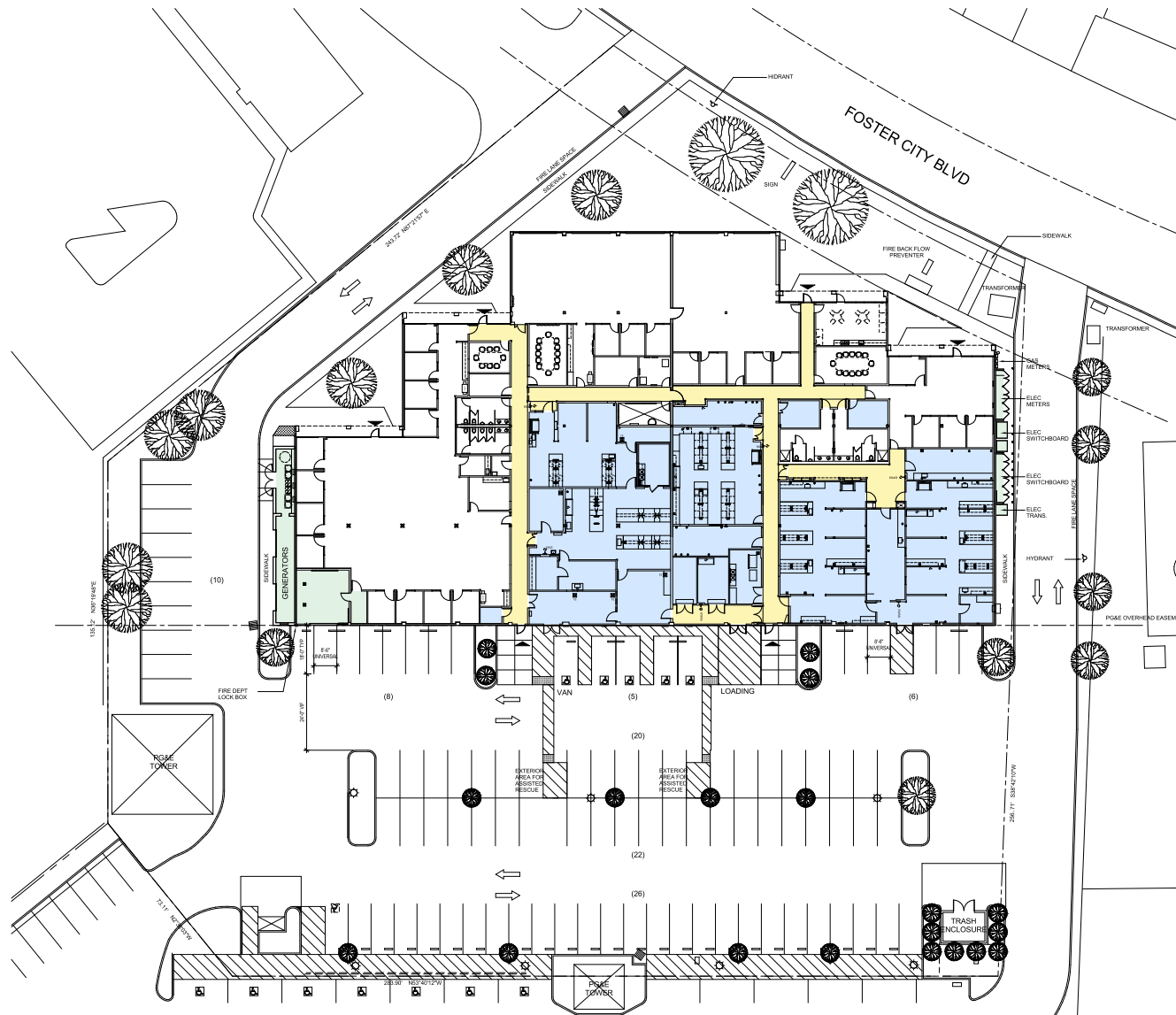

■ = LAB / LAB SUPPORT AREAS
■ = MECHANICAL / ELECTRICAL ROOMS / YARDS

384 Foster City Blvd.

I | P | G

Amenities

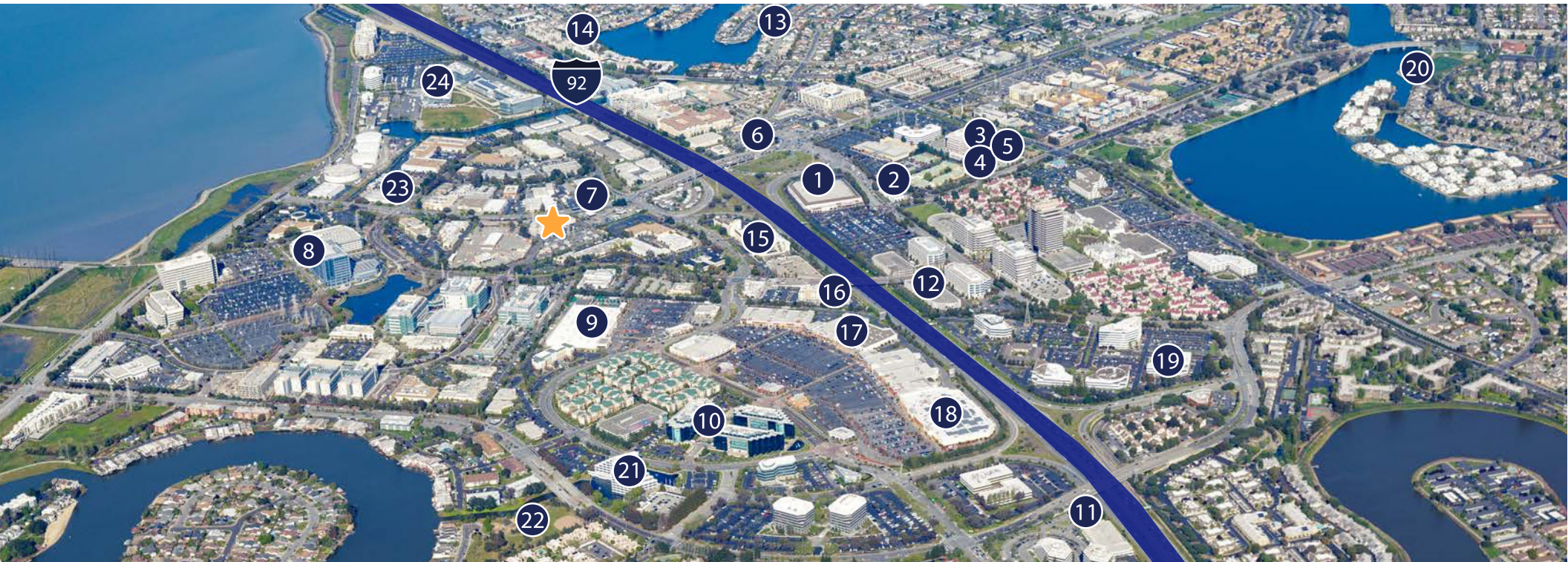

- | | | | |
|-----------------------------------|-------------------|---------------------------------|----------------------------|
| 1 Costco | 7 Tesla | 13 Erckenbrack Park Beach | 19 Camico Mutual Insurance |
| 2 Jamba Juice | 8 Gilead Sciences | 14 Hillbarn Theatre | 20 Catamaran Park |
| 3 Activision | 9 The Home Depot | 15 Cafe Florian Restaurant | 21 Little Late Bird |
| 4 Sling | 10 Playstation | 16 Panera Bread | 22 Mariners Island Park |
| 5 International Business Machines | 11 Apttus | 17 Bridgepointe Shopping Center | 23 Avis Car Rental |
| 6 Starbird Chicken | 12 Visa | 18 Target | 24 Illumina |

384 Foster City Blvd.

Tower II, Suite 1150 | Emeryville CA

I | P | G

Morning Shuttle

Hillsdale Station Pickup	393 Vintage Park Drop-Off*
6:51am	7:04am
7:51am	8:04am
8:51am	9:04am
9:36am	9:49am

Evening Shuttle

393 Vintage Park Pickup*	Hillsdale Station Drop-Off
3:45pm	4:00pm
4:34pm	4:49pm
5:34pm	5:49pm
6:34pm	6:49pm

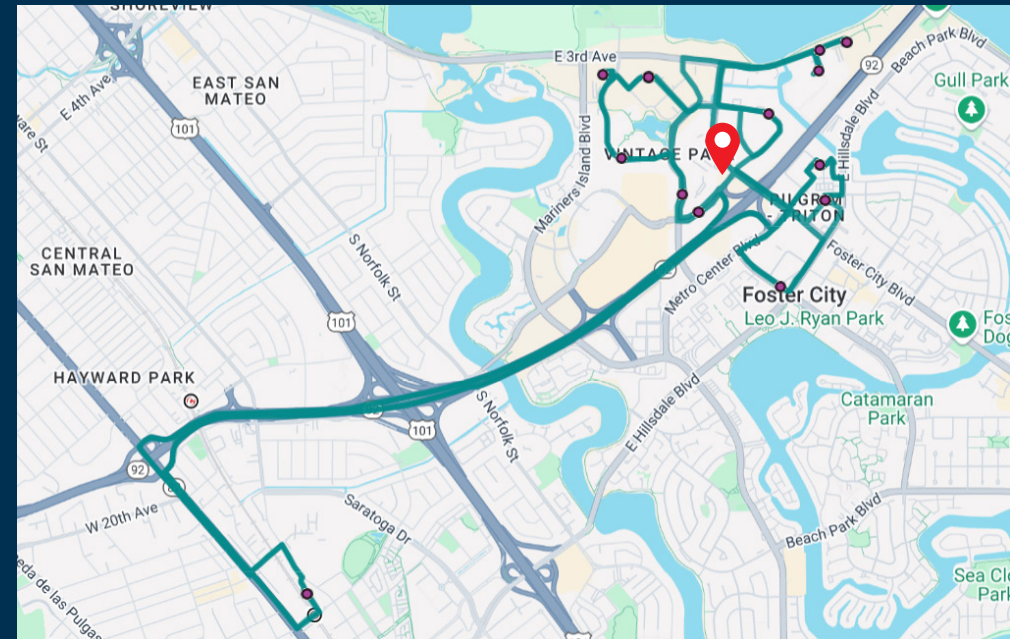

*5 minute walk from Caltrain shuttle

For leasing information

Innovation Properties Group
181 2nd Street, San Francisco, CA
www.ipgsf.com | CL 02031924

Ivan Smiljanic | Partner
510-717-5008 | Ivan@ipgsf.com
DRE: 1995999

Rocky Kile | Director - Re & Lab Infrastructure
401-263-4218 | rocky@ipgsf.com
DRE: 02233435

ipgsf.com

This document has been prepared by IPG for advertising and general information only. IPG makes no guarantees, representations or warranties of any kind, expressed or implied, regarding the information including, but not limited to, warranties of content, accuracy and reliability. Any interested party should undertake their own inquiries as to the accuracy of the information. IPG excludes unequivocally all inferred or implied terms, conditions and warranties arising out of this document and excludes all liability for loss and damages arising there from. This publication is the copyrighted property of IPG and/or its licensor(s). ©2025. All rights reserved.